

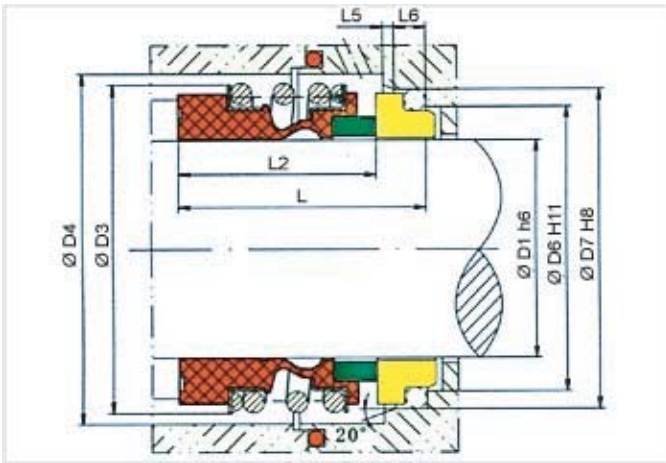

# Mechanical seal

Used in centrifugal pumps, mixer

# ZY-G2



Mechanical seal structure ZY-G2

Temperature	-40 °C ~ +150 °C
Pressure	≤ 1.2 Mpa
Speed	≤ 13 m/sec
Materials	Stationary Ring: Ceramic/SIC/TC Rotary Ring: Carbon/SIC/TC Secondary Seal: NBR/EPDM/VITON Spring & Other parts: SUS304/SUS316

Used in centrifugal pumps, mixer and other rotating equipments. The mediums are the most general and light chemical duties such as sewage and waters.

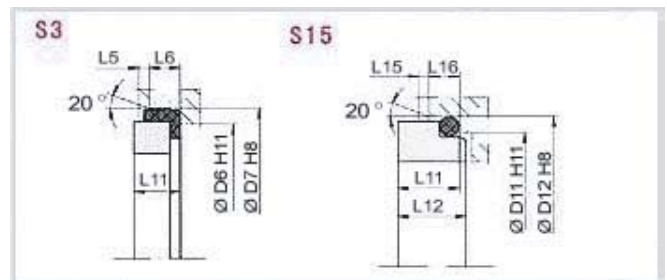
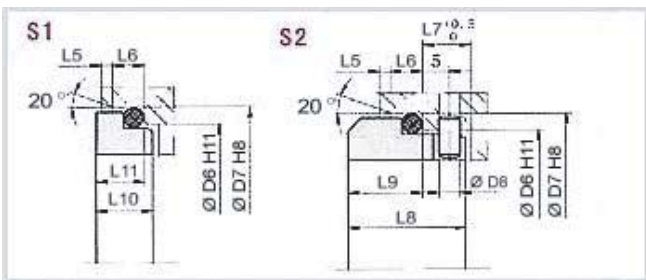

модель	D1	D3	D4	D6	D7	D8	D11	D12	L	L1	L2	L5	L6	L7	L8	L9	L10	L11	L12	L14	L15	L16
ZYG2-12	12	25	26	19	23	3	17.5	21.6	32.5	15	25.9	1.5	4	8.5	17.5	10	7.5	6.6	6.5	5.6	1.2	3.8
ZYG2-14	14	28.5	30	21	25	3	20.5	24.6	35	17	28.4	1.5	4	8.5	17.5	10	7.5	6.6	6.5	5.6	1.2	3.8
ZYG2-15	15	28.5	30	-	-	3	20.5	24.6	-	17	28.4	-	-	-	-	-	-	7.5	6.6	1.2	3.8	
ZYG2-16	16	28.5	30	23	27	3	22	28	35	17	28.4	1.5	4	8.5	17.5	10	7.5	6.6	8.5	7.5	1.5	5
ZYG2-18	18	32	33	27	33	3	24	30	37.5	19.5	30	2	5	9	19.5	11.5	8.5	7.5	9	8	1.5	5
ZYG2-19	19	36	38	-	-	3	-	-	-	21.5	30	2	5	9	19.5	11.5	8.5	7.5	-	-	1.5	5
ZYG2-20	20	37	38	29	35	3	29.5	35	37.5	21.5	30	2	5	9	19.5	11.5	8.5	7.5	8.5	7.5	1.5	5
ZYG2-22	22	37	38	31	37	3	29.5	35	37.5	21.5	30	2	5	9	19.5	11.5	8.5	7.5	8.5	7.5	1.5	5
ZYG2-24	24	42.5	44	33	39	3	32	38	40	22.5	32.5	2	5	9	19.5	11.5	8.5	7.5	8.5	7.5	1.5	5
ZYG2-25	25	42.5	44	34	40	3	32	38	40	23	32.5	2	5	9	19.5	11.5	8.5	7.5	8.5	7.5	1.5	5
ZYG2-28	28	49	50	37	43	3	36	42	42.5	26.5	35	2	5	9	19.5	11.5	8.5	7.5	10	9	1.5	5
ZYG2-30	30	49	50	39	45	3	39.2	45	42.5	26.5	35	2	5	9	19.5	11.5	8.5	7.5	11.5	10.5	1.5	5
ZYG2-32	32	53.5	55	42	48	3	42.2	48	42.5	27.5	35	2	5	9	19.5	11.5	8.5	7.5	11.5	10.5	1.5	5
ZYG2-33	33	53.5	55	42	48	3	44.2	50	42.5	27.5	35	2	5	9	19.5	11.5	8.5	7.5	12	11	1.5	5
ZYG2-35	35	57	59	44	50	3	46.2	52	42.5	28.5	35	2	5	9	19.5	11.5	8.5	7.5	12	11	1.5	5
ZYG2-38	38	59	61	49	56	4	49.2	55	45	30	36	2	6	9	22	14	10	9	11.3	10.3	1.5	5
ZYG2-40	40	62	64	51	58	4	52.2	58	45	30	36	2	6	9	22	14	10	9	11.8	10.8	1.5	5
ZYG2-43	43	65.5	67	54	61	4	53.3	62	45	30	36	2	6	9	22	14	10	9	13.2	12	2	6
ZYG2-45	45	68	70	56	63	4	55.3	64	45	30	36	2	6	9	22	14	10	9	12.8	11.6	2	6
ZYG2-48	48	70.5	74	59	66	4	59.7	68.4	45	30.5	36	2	6	9	22	14	10	9	12.8	11.6	2	6
ZYG2-50	50	74	77	62	70	4	60.8	69.3	47.5	30.5	38	2.5	6	9	23	15	10.5	9.5	12.8	11.6	2	6
ZYG2-53	53	78.5	81	65	73	4	63.8	72.3	47.5	33	36.5	2.5	6	9	23	15	12	11	13.5	12.3	2	6
ZYG2-55	55	81	83	67	75	4	66.5	75.4	47.5	35	36.5	2.5	6	9	23	15	12	11	14.5	13.3	2	6
ZYG2-58	58	85.5	88	70	78	4	69.5	78.4	52.5	37	41.5	2.5	6	9	23	15	12	11	14.5	13.3	2	6
ZYG2-60	60	88.5	91	72	80	4	71.5	80.4	52.5	38	41.5	2.5	6	9	23	15	12	11	14.5	13.3	2	6
ZYG2-65	65	93.5	96	77	85	4	76.5	85.4	52.5	40	41.5	2.5	6	9	23	15	12	11	14.2	13	2	6
ZYG2-68	68	96.5	100	81	90	4	82.7	91.5	52.5	40	41.2	2.5	7	9	26	18	12.5	11.3	14.9	13.7	2	6
ZYG2-70	70	99.5	103	83	92	4	83	92	60	40	48.7	2.5	7	9	26	18	12.5	11.3	14.2	13	2	6
ZYG2-75	75	107	110	88	97	4	90.2	99	60	40	48.7	2.5	7	9	26	18	12.5	11.3	15.2	14	2	6
ZYG2-80	80	112	116	95	105	4	95.2	104	60	40	48	3	7	9	26.2	18.2	13	12	16.2	15	2	6
ZYG2-85	85	120	124	100	110	4	100.2	109	60	41	46	3	7	9	26.2	18.2	15	14	16	14.8	2	6
ZYG2-90	90	127	131	105	115	4	105.2	114	65	45	51	3	7	9	26.2	18.2	15	14	16	14.8	2	6
ZYG2-95	95	132	136	110	120	4	111.6	120.3	65	46	51	3	7	9	25.2	17.2	15	14	17	15.8	2	6
ZYG2-100	100	137	140	115	125	4	114.5	123.3	65	47	51	3	7	9	25.2	17.2	15	14	17	15.8	2	6